



Fitting Instructions For LP0273 TAIL TIDY
HONDA CB500F 2019-



Picture A



Picture B

THIS KIT CONTAINS THE ITEMS PICTURED AND LABELLED OVER PAGE.

SOME PARTS MAY BE SHOWN FOR CLARITY OF INSTRUCTIONS ONLY.

DO NOT PROCEED UNTIL YOU ARE SURE ALL PARTS ARE PRESENT.

PLEASE READ ALL INSTRUCTIONS BEFORE PROCEEDING.

IF IN ANY DOUBT WHEN FITTING OUR PRODUCTS, CONSULT ONE OF OUR DEALERS OR HAVE FITTED BY A QUALIFIED TECHNICIAN.

Please note that the way the kit is packed does not necessarily represent the way of mounting to the bike.

In the event of rubber washers being used to hold components onto bolts, these rubber washers can be thrown away.

DIGITAL COPIES OF THESE INSTRUCTIONS ARE AVAILABLE FROM

www.rg-racing.com

R&G Racing

Unit 1, Shelleys Lane, East Worldham, Alton, Hampshire GU34 3AQ.

Tel: +44 (0)1420 89007 Fax +44 (0)1420 87301 www.rg-racing.com Email: info@rg-racing.com



<u>TOOLS REQUIRED</u>	<u>GENERAL TORQUE SETTINGS</u>
<ul style="list-style-type: none"> • Set of metric Allen keys to include 4 & 5mm A/F size. • 6, 8, 10 & 13mm spanners or sockets. <ul style="list-style-type: none"> • Phillips screwdriver. • Cable cutters. 	M4 BOLT = 8Nm M5 BOLT = 12Nm M6 BOLT = 15Nm M8 BOLT = 20Nm M10 BOLT = 40Nm M12 BOLT = 40Nm

LEGEND

ITEM NO.	DESCRIPTION	QTY
ITEM 1	LA0002 No. PLATE LIGHT inc	1
ITEM 2	LICENCE PLATE BRACKET (TB0198 Part 2)	1
ITEM 3	INDICATOR ADAPTORS (I0031)	4
ITEM 4	INDICATOR SPACERS (I0032)	2
ITEM 5	M6 WASHER	8
ITEM 6	M6 x 6mm LONG BUTTON HEAD BOLTS	4
ITEM 7	M6 x 30mm LONG BUTTON HEAD BOLTS	4
ITEM 8	MOUNTING BRACKET (TB0198 Part 1)	1
ITEM 9	SPACER PLATE (TB0198 Part 3)	2
ITEM 10	M6 NYLOC NUTS	4
ITEM 11	2.5mm CABLE TIES	3
ITEM 12	150mm LENGTH OF HEATSHRINK	3
ITEM 13	REFLECTOR	1
ITEM 14	SELF-ADHESIVE CABLE CLIPS	2
ITEM 15	No. PLATE ILLUMINATOR / INDICATOR CONNECTORS (CON0009)	3

R&G Racing

Unit 1, Shelleys Lane, East Worldham, Alton, Hampshire GU34 3AQ.

Tel: +44 (0)1420 89007 Fax +44 (0)1420 87301 www.rg-racing.com Email: info@rg-racing.com



ASSEMBLY DIAGRAM

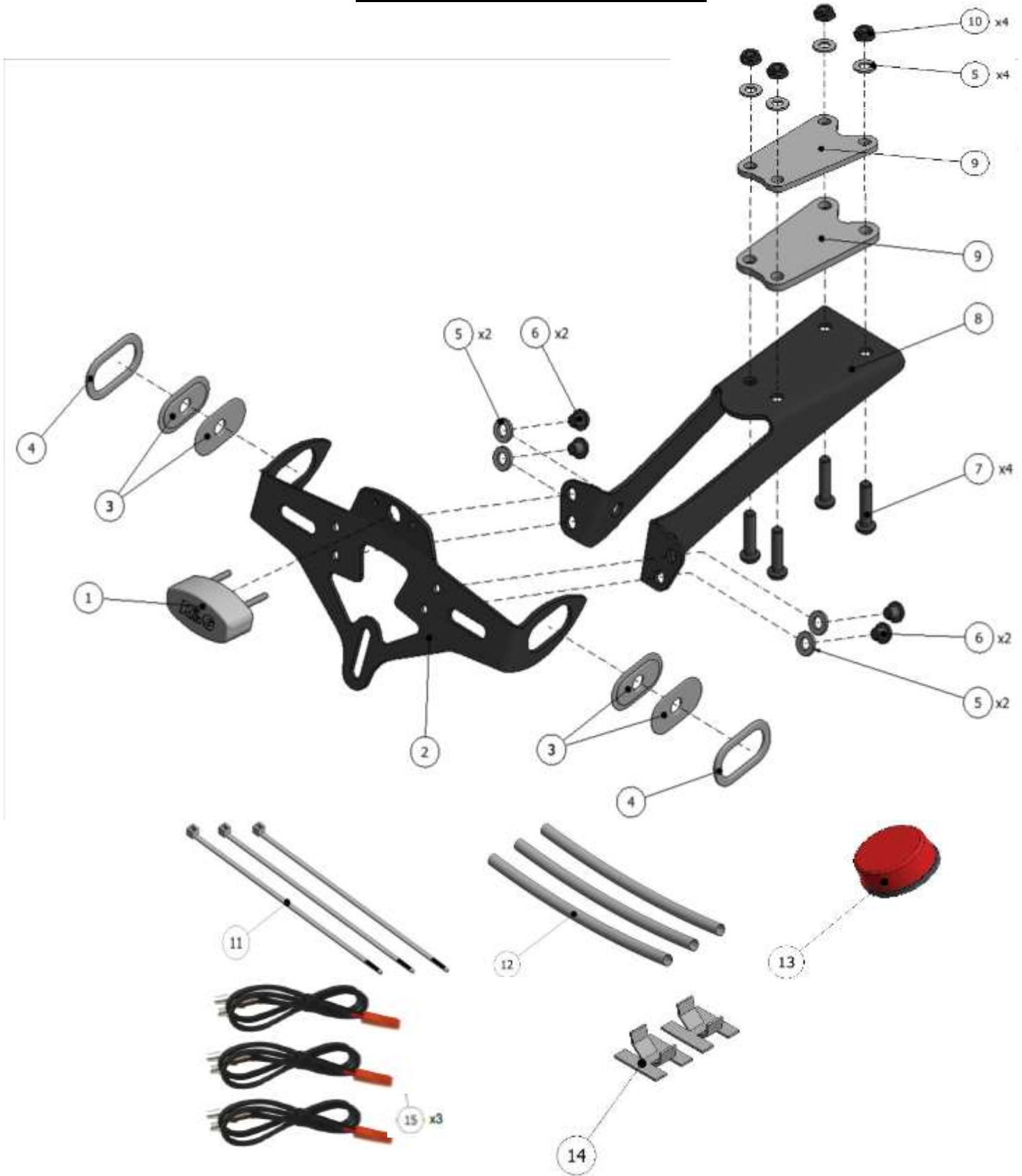

R&G Racing

Unit 1, Shelleys Lane, East Worldham, Alton, Hampshire GU34 3AQ.

Tel: +44 (0)1420 89007 Fax +44 (0)1420 87301 www.rg-racing.com Email: info@rg-racing.com



Picture 1



Picture 2



Picture 3



Picture 4



Picture 5



Picture 6

R&G Racing

Unit 1, Shelleys Lane, East Worldham, Alton, Hampshire GU34 3AQ.

Tel: +44 (0)1420 89007 Fax +44 (0)1420 87301 www.rg-racing.com Email: info@rg-racing.com



Picture 7



Picture 8



Picture 9



Picture 10



Picture 11



Picture 12

R&G Racing

Unit 1, Shelleys Lane, East Worldham, Alton, Hampshire GU34 3AQ.

Tel: +44 (0)1420 89007 Fax +44 (0)1420 87301 www.rg-racing.com Email: info@rg-racing.com



Picture 13



Picture 14



Picture 15



Picture 16



Picture 17



Picture 18

R&G Racing

Unit 1, Shelleys Lane, East Worldham, Alton, Hampshire GU34 3AQ.

Tel: +44 (0)1420 89007 Fax +44 (0)1420 87301 www.rg-racing.com Email: info@rg-racing.com



Picture 19



Picture 20



Picture 21



Picture 22

FITTING INSTRUCTIONS

- To fit the R&G tail tidy, remove the pillion seat using the key.
- Underneath the pillion seat, disconnect the orange, blue and white connectors for the licence plate illuminator light and two indicators, as shown in picture 1.
- Remove the four bolts that mount the OEM licence plate hanger in place and support the licence plate whilst feeding the wires out and removing from the bike, as shown in pictures 2, 3 & 4.

R&G Racing

Unit 1, Shelleys Lane, East Worldham, Alton, Hampshire GU34 3AQ.

Tel: +44 (0)1420 89007 Fax +44 (0)1420 87301 www.rg-racing.com Email: info@rg-racing.com



FITTING INSTRUCTIONS

- To fit the R&G tail tidy, remove the pillion seat using the key.
- Underneath the pillion seat, disconnect the orange, blue and white connectors for the licence plate illuminator light and two indicators, as shown in picture 1.
- Remove the four bolts that mount the OEM licence plate hanger in place and support the licence plate whilst feeding the wires out and removing from the bike, as shown in pictures 2, 3 & 4.
- Remove the plastic undertray from the OEM licence plate hanger by removing the two bolts that are positioned as arrowed in picture 5.
- Remove the domed nut on either indicator, as arrowed in picture 6, and remove the metal plate on the inside before feeding the indicator and wiring out through the hole, as shown in picture 7.
- Repeat the above procedure for the remaining indicator.
- With the indicator removed, the rubber mount now needs to be pulled from the licence plate hanger, as shown in picture 8.

The indicator and mounting parts removed are shown in picture 9, along with the domed nut.

- Take the R&G mounting bracket (item 8 – TB0198 Part 1) and fit it to the R&G licence plate bracket (item 2 – TB0198 Part 2) using the four M6 x 6mm button head bolts (item 6) and four M6 washers (item 5), as shown in pictures 10 & 11, by fitting the bolts from behind as shown.
- Take the R&G licence plate illuminator (item 1 – LA0002) and fit the shroud using a small amount of superglue, before fitting it to the licence plate bracket, as shown in picture 12, before fitting the washer and nuts on the rear and tightening. Fit one length of heatshrink to the wires for protection.
- Take both spacer plates (item 9 – TB0198 Part 3) and offer them into place on the top mounting face of the tail tidy assembly, before locating the four M6 x 30mm long button head bolts (item 7) through the mounting bracket and then through the four holes on the spacer plates, as shown in picture 13.
- Offer this assembly up to the underside of the tail and locate the four bolts through the four mounting holes in the bodywork/subframe, before fitting one M6 washer (item 5) and one M6 nyloc nut (item 10) to the exposed thread on each bolt, as shown in picture 15. Tight-

If fitting R&G Mini Indicators

- To fit the R&G Mini Indicators, fit one length of heat shrink to the wires of each indicator.
- Position two indicator adaptors (item 3 – I0031) onto the wiring of each indicator, ensuring the sides facing each other have the raised centre profile, before fitting the flanged nut supplied, as shown in picture 16.

Fit either indicator through the large slot on the either side of the tail tidy, locating the indicator adaptors either side of the metal bracket, before fitting the nut onto the exposed thread

R&G Racing

Unit 1, Shelleys Lane, East Worldham, Alton, Hampshire GU34 3AQ.

Tel: +44 (0)1420 89007 Fax +44 (0)1420 87301 www.rg-racing.com Email: info@rg-racing.com



If fitting OEM Indicators

- Fit one indicator spacer (item 4 – I0032) to both rubber indicator mounts, as shown in picture 18, before fitting into the large slot on either side of the tail tidy, ensuring the shallower side of the rubber mount is on the inside.
- Take the OEM indicator, and feed the wiring through the hole in the rubber mount, before sliding the metal bracket onto the wiring in the same way as it was removed from the bike, as shown in picture 19.
- Once fitted, fit the domed nut and tighten to secure the indicator in place, as shown in picture 20.
- Repeat the above process for both indicators.
- With the indicators of choice fitted, feed the wiring through the two holes on either spar of the tail tidy, as shown in pictures 21 & 22 and feed the indicator and licence plate illuminator wiring up through the exposed hole on the underside of the tail bodywork. *Use the cable ties and self-adhesive cable clips supplied to route the wiring neatly.*
- Take the three connectors supplied (item 15 – CON0009) and connect one from the licence plate illuminator to the OEM connector (*if illumination fails, reverse the bullet connectors*).
- Fit the remaining two connectors to the indicator wiring as below:
- **If fitting R&G Aero Indicators with LED's the yellow wire on the Aero Indicators connects with the black wire on the CON0009 and the black wire on the Mini Indicators connects with the red wire on the CON0009.** 1x set of RGR0001 & RGR0002 resistors (mounted inline) (available separately) are required to achieve the correct flash rate.
- If fitting R&G Mini Indicators with bulbs, the black wire on the Mini Indicators connects with the black wire on the CON0009 and the black/white wire on the Mini Indicators connects with the red wire on the CON0009.
- If fitting R&G LED Mini Indicators, the black wire on the Mini Indicators connects with the red wire on the CON0009 and the black/white wire on the Mini Indicators connects with the black wire on the CON0009. 1x set of RGR0001 & RGR0002 resistors (mounted inline) (available separately) are required to achieve the correct flash rate.
- Connect each connector up to the OEM wiring and check for the correct operation of all lights.
- Neatly secure the wiring within the tail unit using the cable ties supplied.
Re-fit the pillion seat.
- Ensure the tail tidy is securely mounted and all bolts are fully tightened.
- Re-fit the licence plate (it may require drilling).
- Depending on local laws, attach enclosed reflector in an appropriate location.
- Test the licence plate illuminator and all lights before riding.

ISSUE 1 12/08/2019 (BG)

R&G Racing

Unit 1, Shelleys Lane, East Worldham, Alton, Hampshire GU34 3AQ.

Tel: +44 (0)1420 89007 Fax +44 (0)1420 87301 www.rg-racing.com Email: info@rg-racing.com



CONSUMER NOTICE

The catalogue description and any exhibition of samples are only broad indications of the Products and R&G may make design changes which do not diminish their performance or visual appeal and supplying them in such state shall conform to the order. The Buyer acknowledges no representation or warranty (other than as to title) has been **given or will apply to the Products other than those in R&G's order or confirmation and the Buyer confirms it has chosen the Products as being of merchantable quality and suitable for its particular purposes.** Where R&G fits the Products or undertakes other services it shall exercise reasonable skill and care and rectify any fault free of charge unless the workmanship has been disturbed. The Buyer is responsible for ensuring that the warranty on the motorcycle is not affected by the fitting of the Products. On return of any defective Products R&G shall at its option either supply a replacement or refund the purchase money but shall not be liable if the Products have been modified or used or **maintained otherwise than in accordance with R&G's or manufacturer's instructions and good engineering practice** or if the defect arises from accident or neglect. Other than identified above and subject to R&G not limiting its liability for causing death and personal injury, it shall not be liable for indirect or consequential loss and otherwise its liability shall be limited to the amounts paid by the Buyer for the Products or the fitting or service concerned. These terms do **not affect the Buyer's statutory rights.**

R&G RACING RETURNS POLICY (NON-FAULTY GOODS)

Returns must be pre-authorised (if not pre-authorised the return will be rejected). Goods may only be returned direct to us if they were purchased direct from us (customer must prove if necessary). Otherwise to be returned to original vendor. Goods must be in re-sellable condition, in the opinion of R&G Racing. All returns are subject to a 25% re-stocking and handling fee (25% of the gross value exc. P&P – at the prevailing price at time of purchase). The customer must pay any and all carriage charges. No returns of discontinued products, unless within 14 days of purchase. This policy does not affect your statutory rights and does not refer to faulty goods.

R&G Racing

Unit 1, Shelleys Lane, East Worldham, Alton, Hampshire GU34 3AQ.

Tel: +44 (0)1420 89007 Fax +44 (0)1420 87301 www.rg-racing.com Email: info@rg-racing.com